

BabyLock & Brother Zippy Bonus Set #2

1010 & 1016 Quilted Zippy Bag

Supplies needed:

Embroidery/sewing machine in good working order
 Power cord
 BabyLock or Brother hoop – 10 5/8" x 16" (272mm x 408mm)
 80/12 Quilting Needle
 Polyester or Rayon Embroidery threads
 Embroidery bobbin
 Floriani's No Show Mesh
 Collins Wonder Tape
 1/4" Steam a Seam Lite
 Scotch Magic tape or Satin or Matte – not the shiny kind
 Pinking Shears or Rotary cutter with Pinking blade
 General sewing supplies
 Owner's Manual



www.apjproject.com
 Copyright 2006-2019 by A P J Project All rights reserved

Materials needed for 1 Zippy Bag:

See Page 7

Recommended Fabric:

Front and back - Quilt Weight Cotton or Blend

Lining - Quilt Weight Cotton or Blend

Batting – Warm and Natural

Applique (prepare the fabric with Applique Wonder or Appli Stick) - Quilt Weight Cotton or Blend

PROJECT DESCRIPTION

Bonus Design for BabyLock Solaris and Brother Luminaire 10 5/8" x 16 Hoops –

Finished size of 1010 Zippy is 9 3/4" x 9 3/4" , 1016 Zippy is 9 3/4" x 15"

Construction is the same as the club size.

AccuQuilt Go! Dies used for Applique shapes - #55012 Go! Circle-2",3",5", #55029 Go! Heart-2",3",4", #55028 Go! Star-2",3",4", #55011 GO! Hexagon - 1", 1 1/2", 2 1/2" Sides, #55045 Go! Rose of Sharon and #55382 Go! Rose of Sharon #2

DESIGN INFO – images not to scale

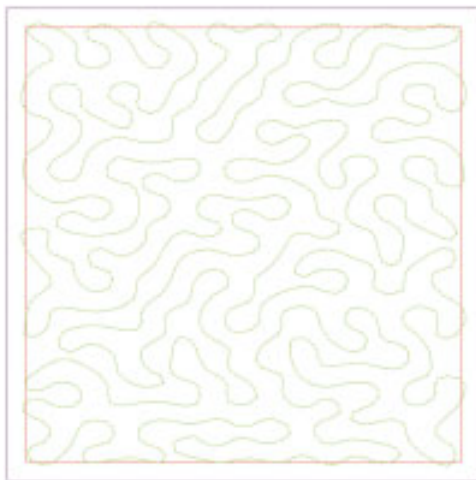

1010back
 268.2x268.2 mm (10.56x10.56 ")
 2348 stitches



1010circle
 268.2x268.2 mm (10.56x10.56 ")
 5814 stitches

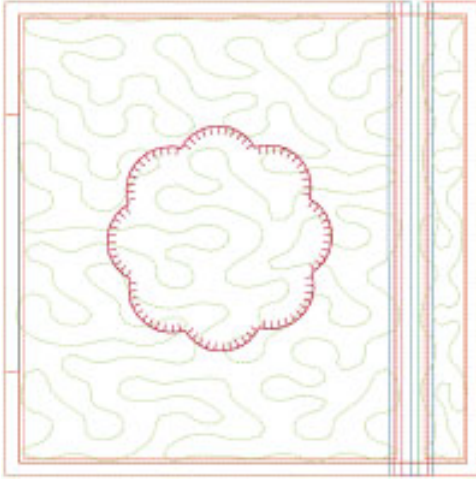

1010flower
268.2x268.2 mm (10.56x10.56 ")
5873 stitches

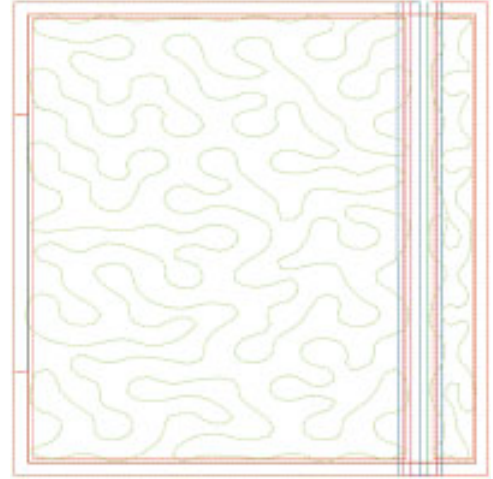

1010front
268.2x268.2 mm (10.56x10.56 ")
4622 stitches



1010heart
268.2x268.2 mm (10.56x10.56 ")
5628 stitches

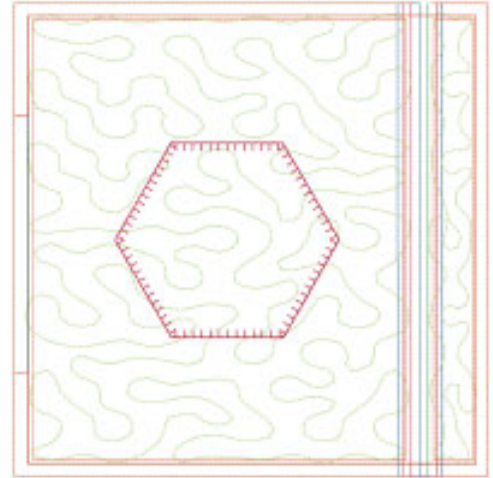

1010hex
268.2x268.2 mm (10.56x10.56 ")
5739 stitches



1010star
268.2x268.2 mm (10.56x10.56 ")
6061 stitches

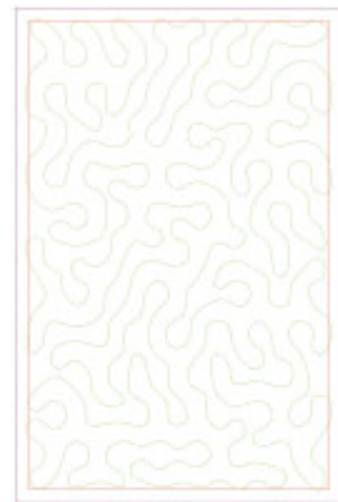

1016back
268.2x406.0 mm (10.56x15.98 ")
2920 stitches

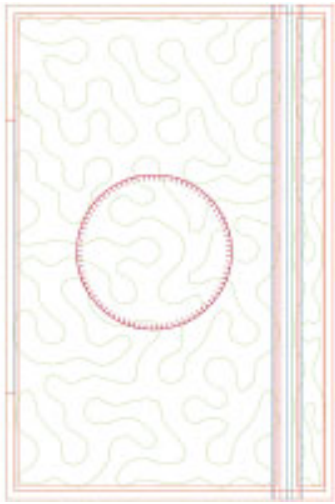

1016circle
 268.2x406.0 mm (10.56x15.98 ")
 7096 stitches



1016flower
 268.2x406.0 mm (10.56x15.98 ")
 7153 stitches



1016front
 268.2x406.0 mm (10.56x15.98 ")
 5907 stitches



1016heart
 268.2x406.0 mm (10.56x15.98 ")
 6911 stitches

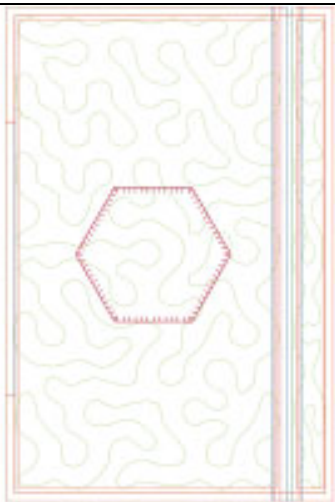

1016hex
 268.2x406.0 mm (10.56x15.98 ")
 7019 stitches



1016star
 268.2x406.0 mm (10.56x15.98 ")
 7342 stitches

DESIGN INFO – images not to scale – Applique Designs

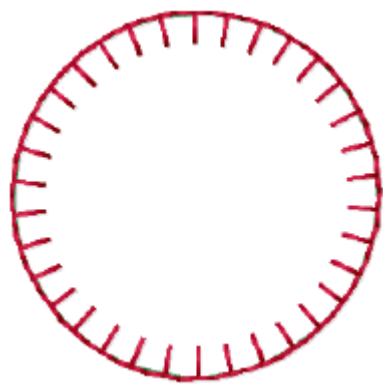

2circle
51.2x51.0 mm (2.02x2.01 ")
487 stitches



2flower
51.8x51.6 mm (2.04x2.03 ")
582 stitches

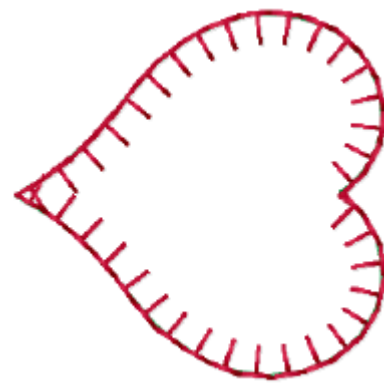

2heart
52.2x51.6 mm (2.06x2.03 ")
524 stitches

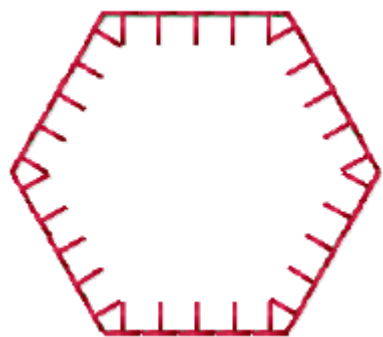

2hex
51.0x44.6 mm (2.01x1.76 ")
919 stitches



2star
50.0x52.6 mm (1.97x2.07 ")
591 stitches

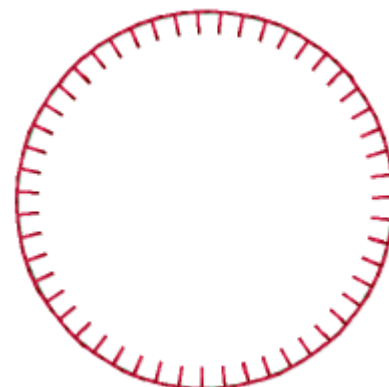

3circle
76.4x76.4 mm (3.01x3.01 ")
719 stitches

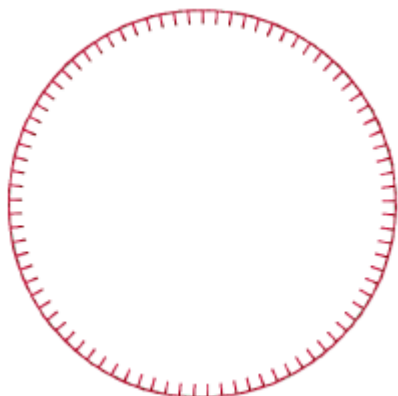

5circle
127.0x127.2 mm (5.00x5.01 ")
1186 stitches

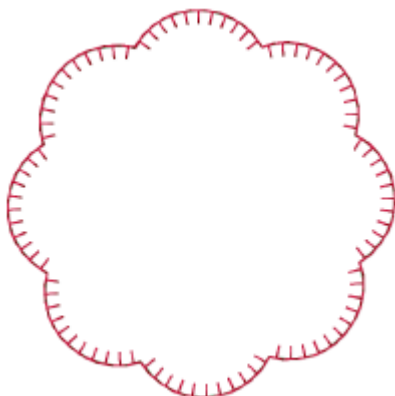

5flower
127.4x127.4 mm (5.02x5.02 ")
1240 stitches

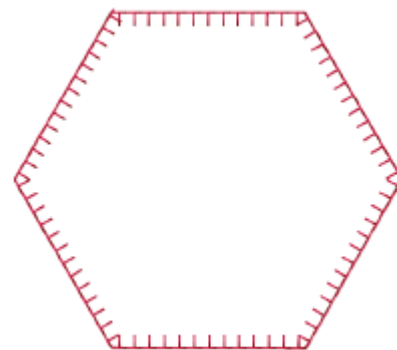

5hex
127.0x111.4 mm (5.00x4.39 ")
1107 stitches

PROJECT PICTURE – this is the 1016 size



10 x 16 SIZE LAYOUT OPTIONS – Appliques from Zippy Bonus set #1 and Zippy Bonus set #2

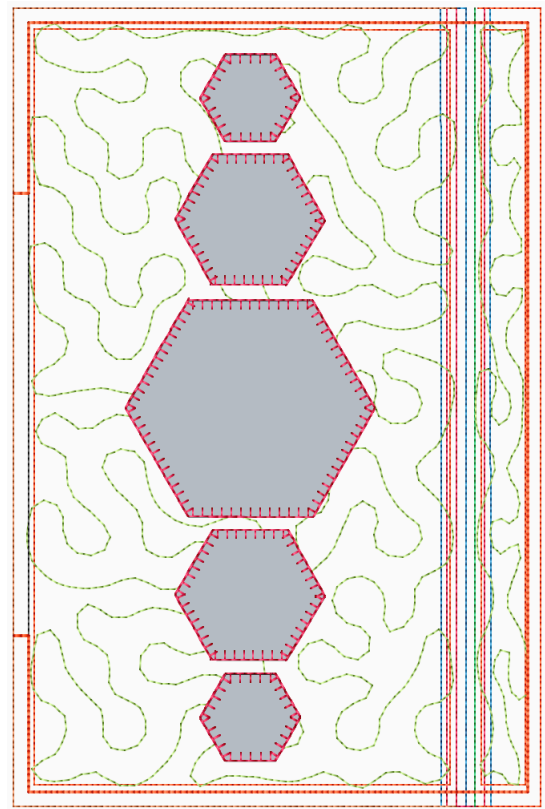
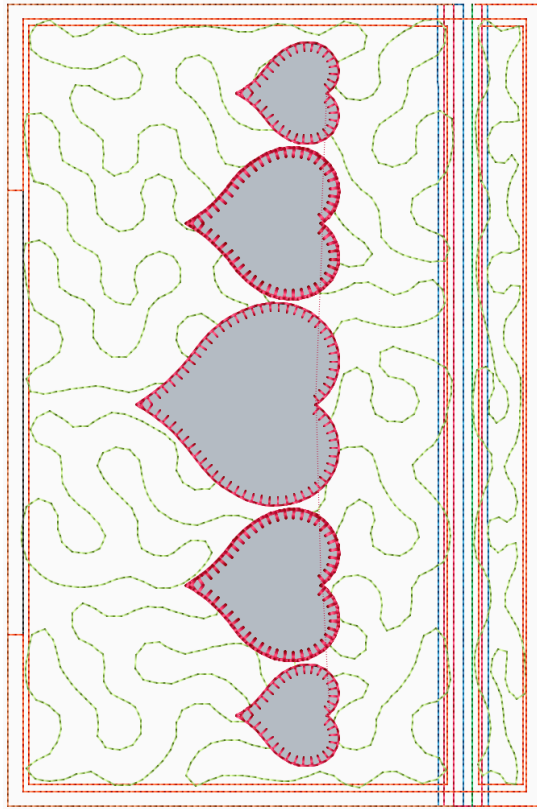
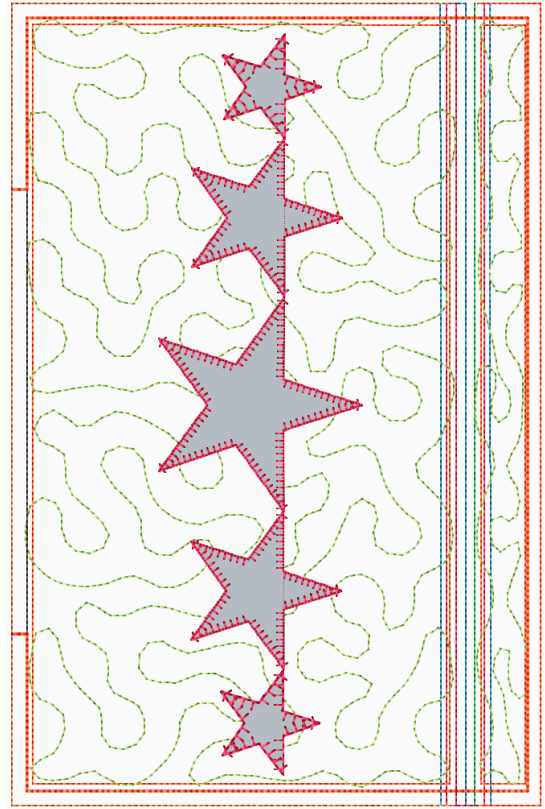
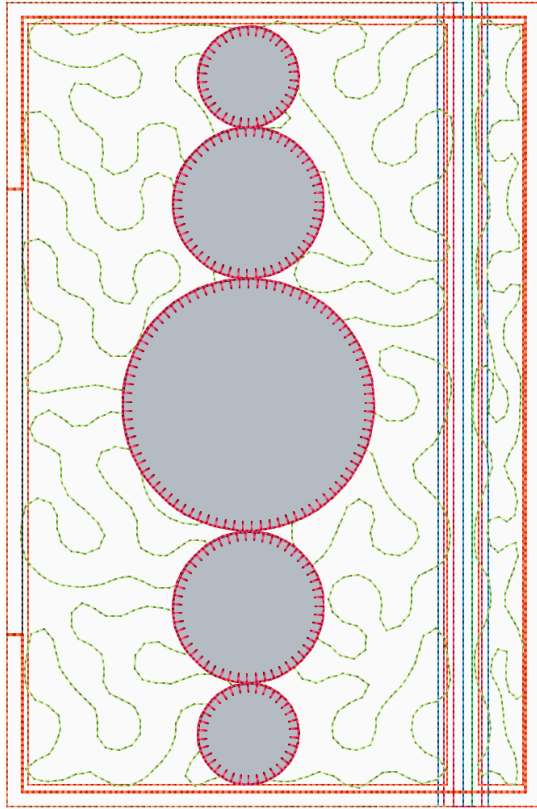

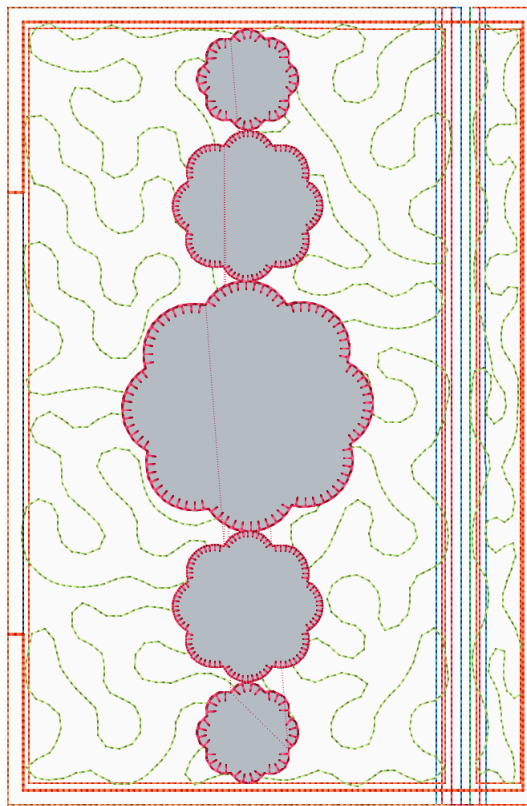

PART LABELS – CUT THESE OUT AND USE THEM TO LABEL YOUR PARTS – 10 x 10 size

Zipper – 1 – 12" or longer Nylon or Polyester		Ribbon – 6" of ½" to 1" Grosgrain or Satin ribbon
Front Main Outside 1 piece – 9 ¾" x 11"	Front Top Outside 1 piece – 2 ¼" x 11"	Back Outside 1 piece - 11" x 11"
Front Main Lining 1 piece – 9 ¾" x 11"	Front Top Lining 1 piece – 2 ¼" x 11"	Back Lining 1 piece - 11" x 11"
Front batting 1 piece – 7/8" x 9 ¾"	Front batting 1 piece – 8 3/8" x 9 ¾"	Back Batting 1 piece – 9 ¾" x 9 ¾"

PART LABELS – CUT THESE OUT AND USE THEM TO LABEL YOUR PARTS – 10 x 16 size

Zipper – 1 – 20" or longer Nylon or Polyester		Ribbon – 6" of ½" to 1" Grosgrain or Satin ribbon
Front Main Outside 1 piece – 9 ¾" x 16 ½"	Front Top Outside 1 piece – 2 ¼" x 16 ½"	Back Outside 1 piece - 11" x 16 ½"
Front Main Lining 1 piece – 9 ¾" x 16 ½"	Front Top Lining 1 piece – 2 ¼" x 16 ½"	Back Lining 1 piece - 11" x 16 ½"
Front batting 1 piece – 7/8" x 15"	Front batting 1 piece – 8 3/8" x 15"	Back Batting 1 piece – 9 ¾" x 15"